

# GROUND FLOOR PLAN

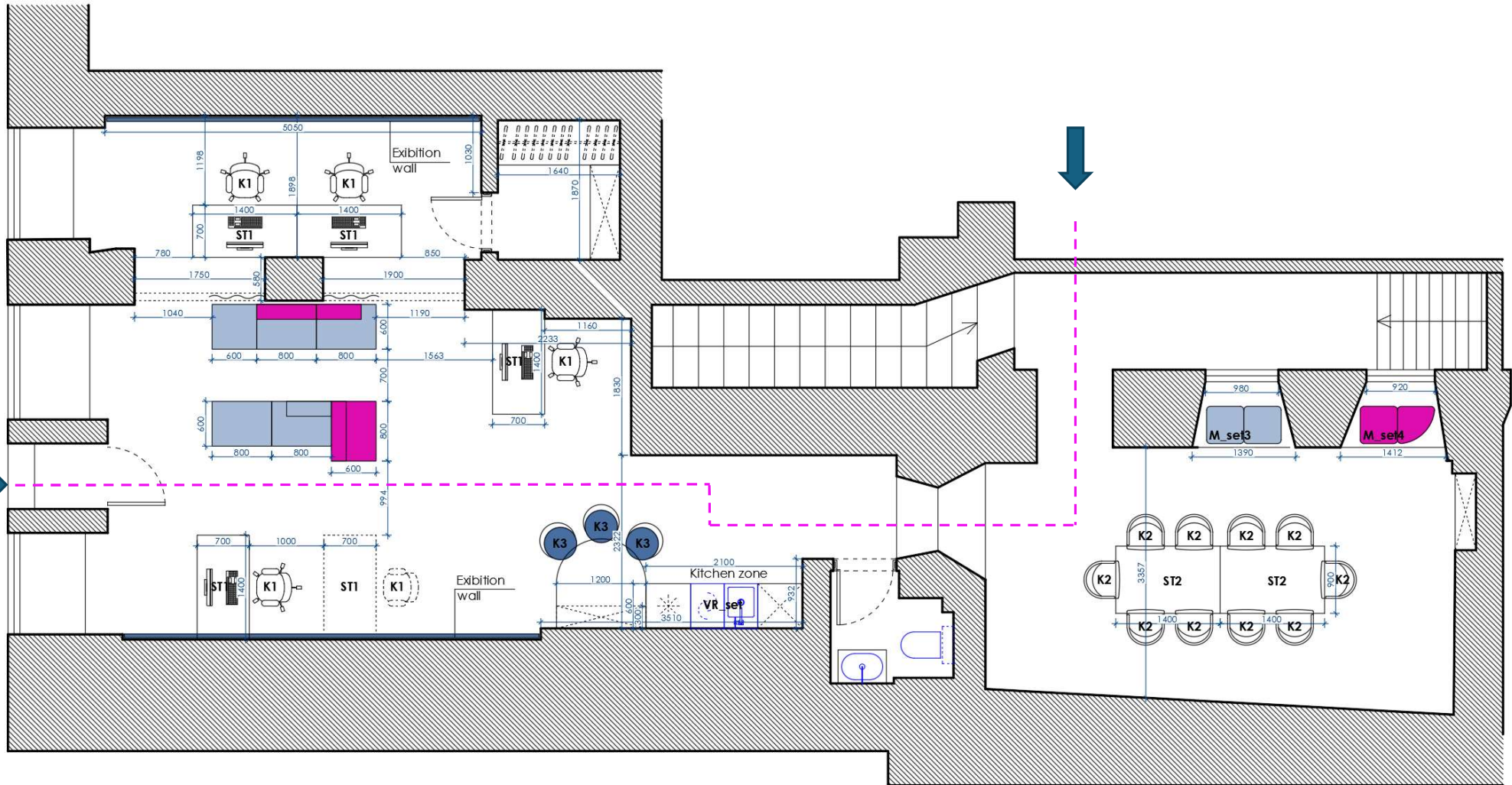

BASEMENT PLAN

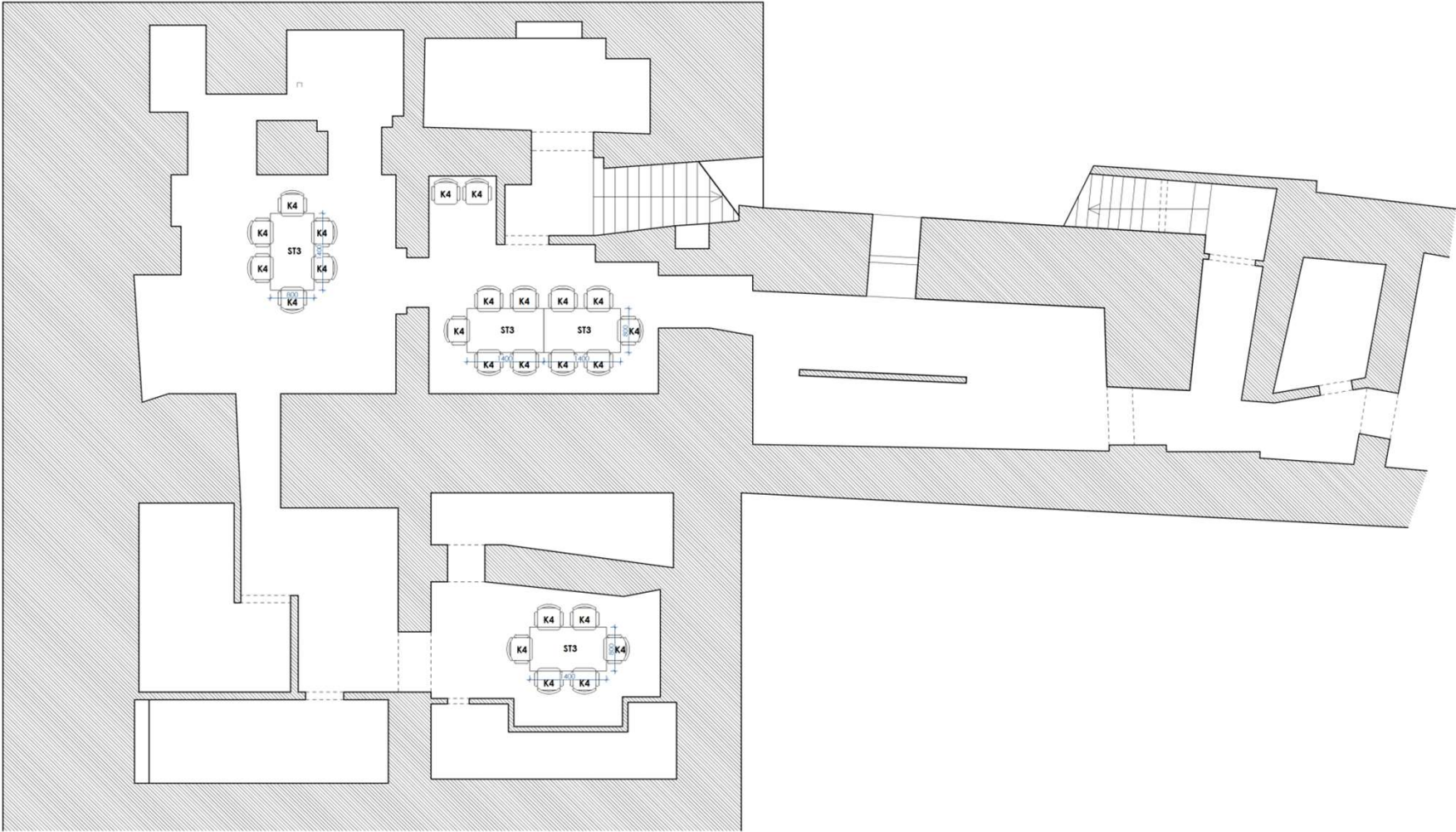

## COLORS

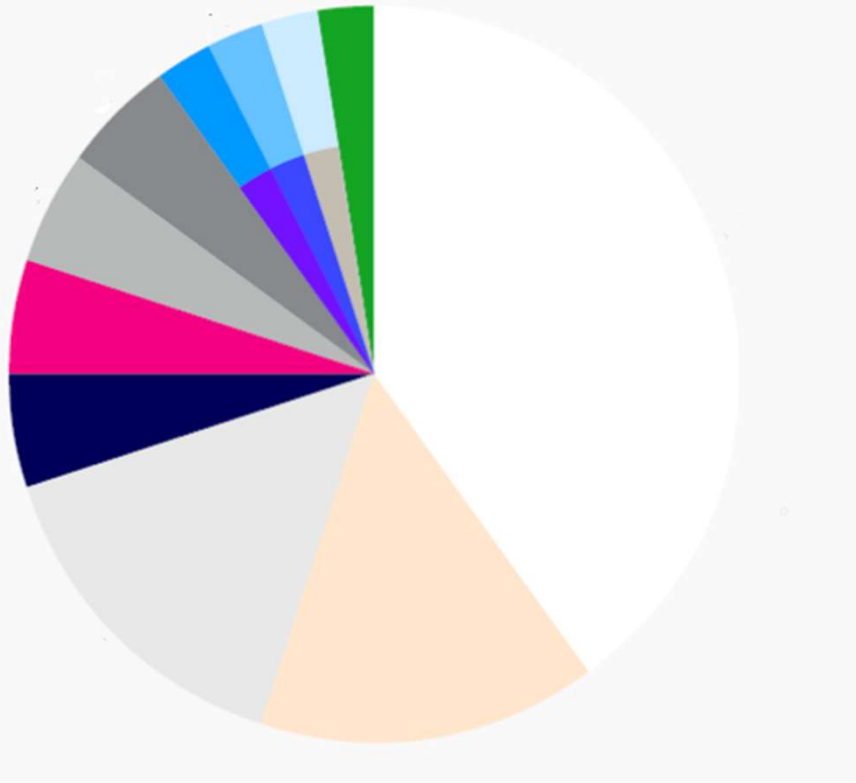

Overall proportions

Foundation primary colors-dark blue and magenta- are bold and vibrant so we recommend to take care that they don't overwhelm spaces. Brand colors work best when they are used as highlights or accents. This can be on walls, furniture, fabric, displays and communications.

RAL 5010, RAL 4010



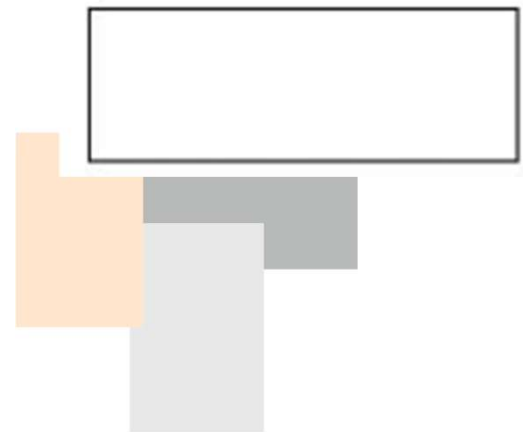





base











accents



# COLORS TRANSLATION INTO MATERIALS

Structure	
	White walls
	Glass
	Light wood
	Light grey accents
	Accent walls
	Tinted orange floor or wall accents
	Metal
	Ceramic

Office furniture	
	Laminated or painted white
	Light wood
	Powder-coated metal
	Glass, mirror
	Metal

Soft furniture: Carpets, soft furnishings, sofas, chairs, cushions	
	Grey with glitter
	Dark blue fabric
	Magenta fabric
	Shades of purple, blue or orange



## MOODBOARD FOR FINISHES-NR.2-OLD TOWN ROOFS

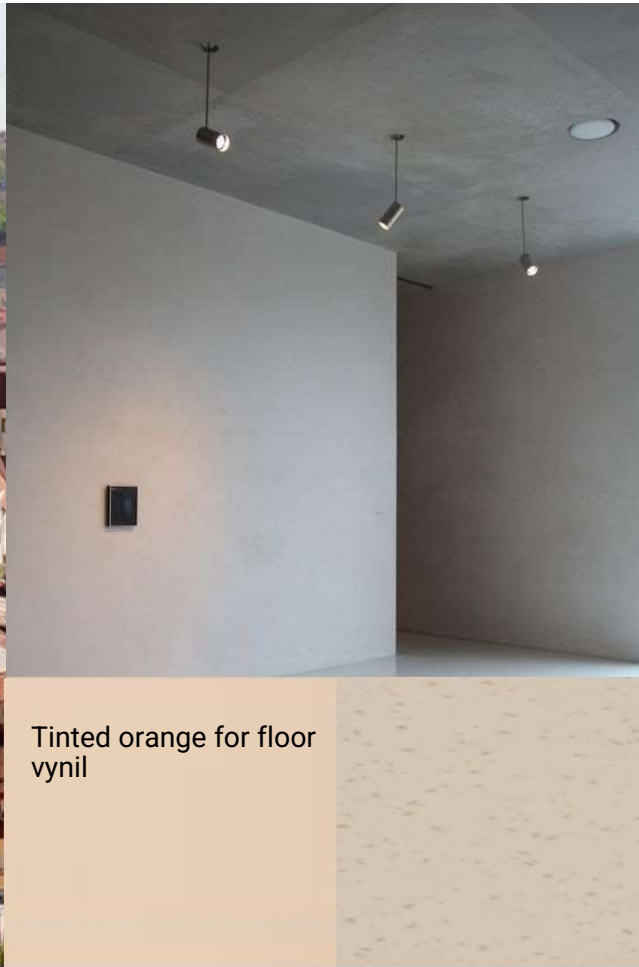

Tinted orange for floor  
vynil



## Concept for furniture and decor

Serene surrounding and splash of colour through textile, furniture and other decor

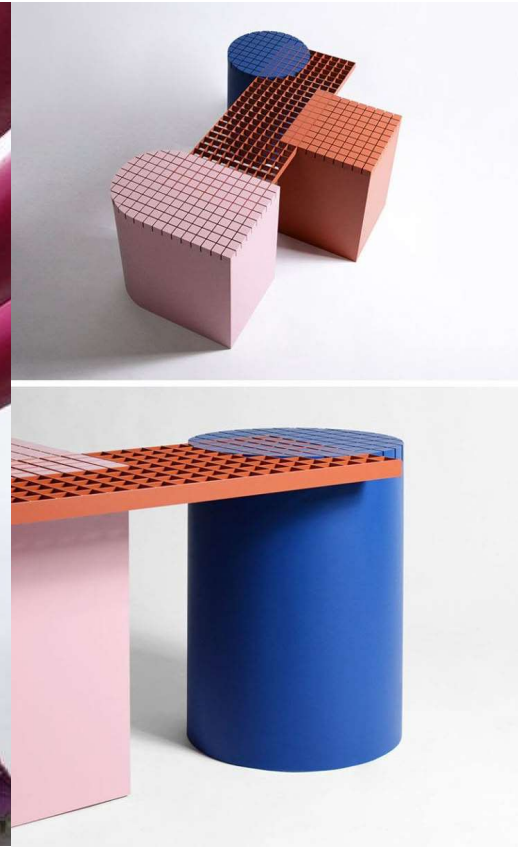



## WORKSTATION



- Workstation:
- Height adjustable desk
  - Privacy screen (upholstered and only horizontal)
  - Drawers+seat in one
  - Wires management
  - Individual lighting for individual workspace



## MODULAR SEATS

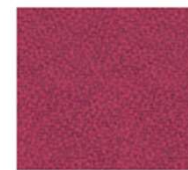

**Y57 Extreme  
Plus**

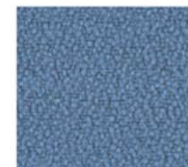

**Y51 Extreme  
Plus**



MODULAR SEATS

Collection has to have fabric choice similar to brand colors. Fabrics colors have to be chosen with supplier, plan does not indicate that certain parts must be in magenda or blue.

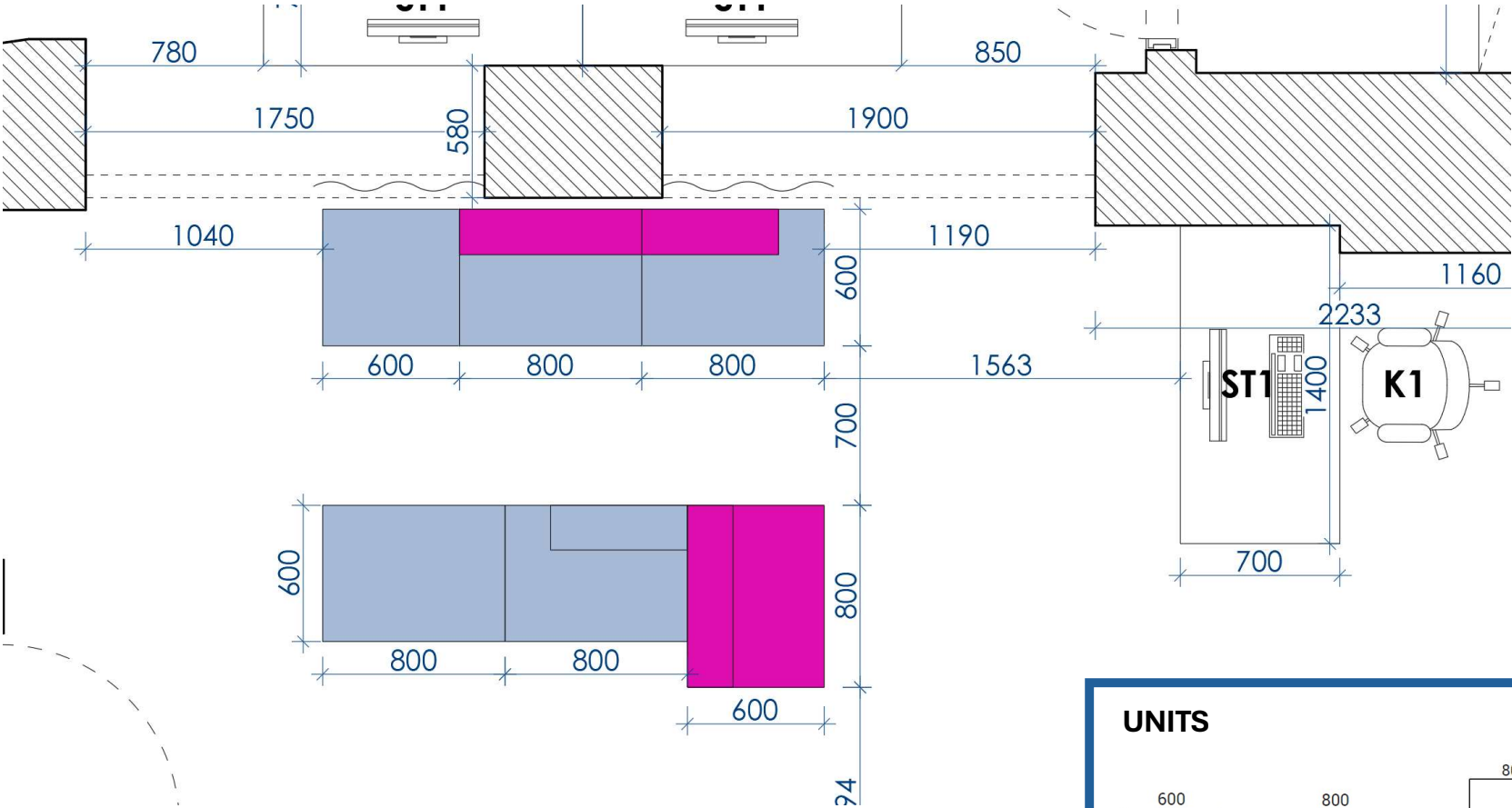

UNITS

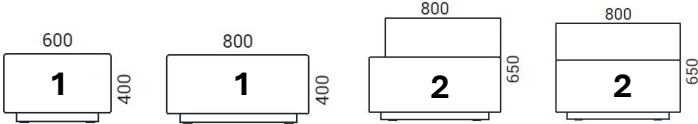

## KITCHEN COLOR SCHEME



-Party kitchen with bar for guests and employees instead of reception

KITCHEN

STOOL

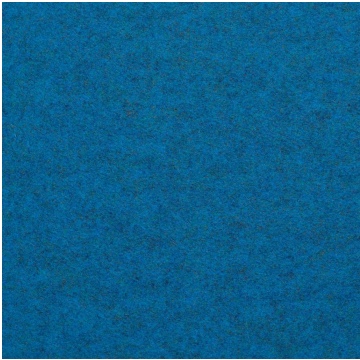



## KITCHEN



## KITCHEN

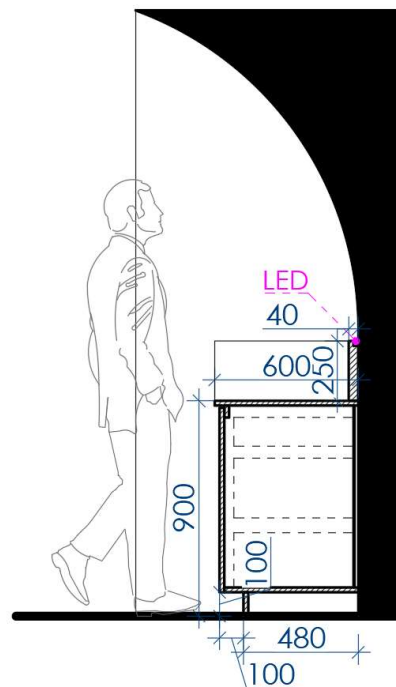
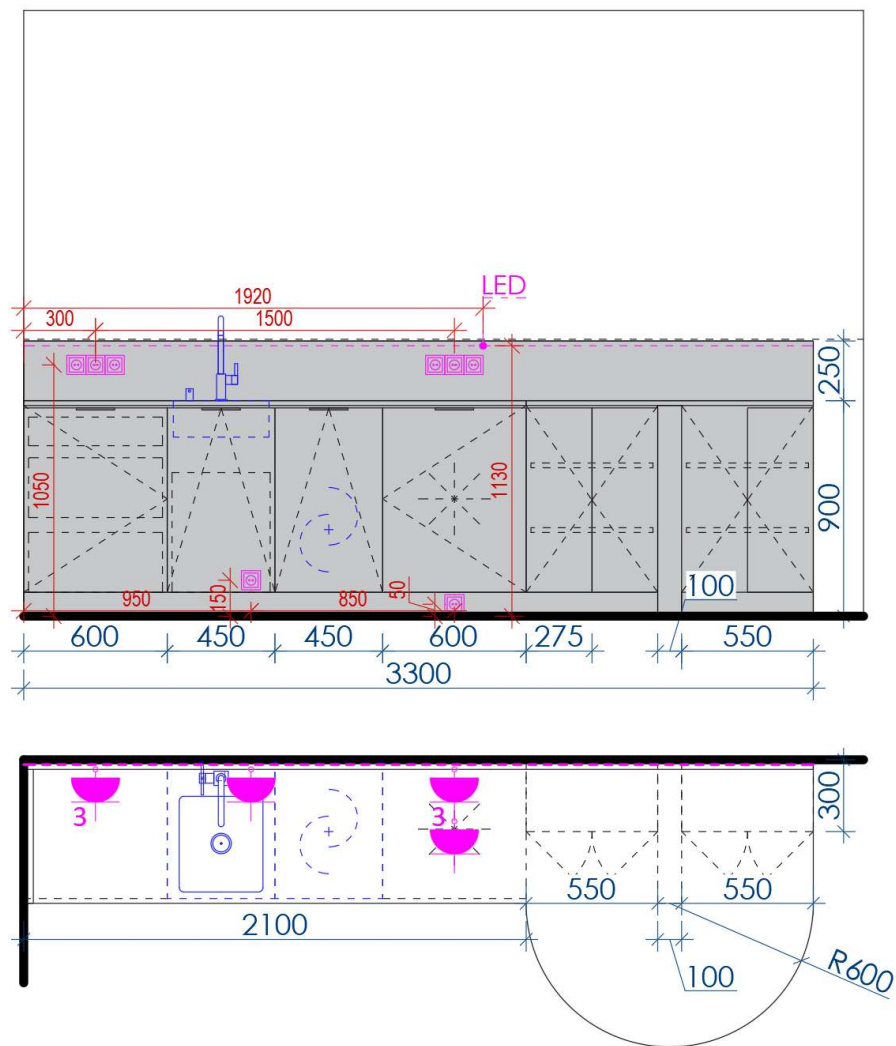

## WORKTOP:

Compact HPL 10 A456, black core

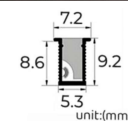

**LED PROFILE: black**

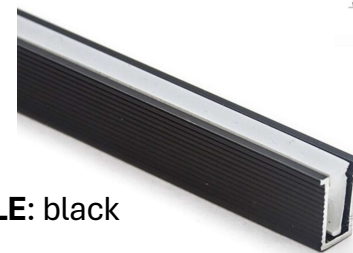

**HANDLES:**  
BRASA, P-  
A24NP



**LAMINATE:**  
CLEAF IDEA  
FB81

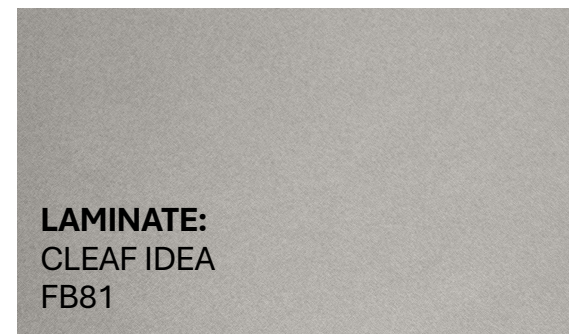

## KITCHEN MATERIALS





## WARDROBE DRAWING

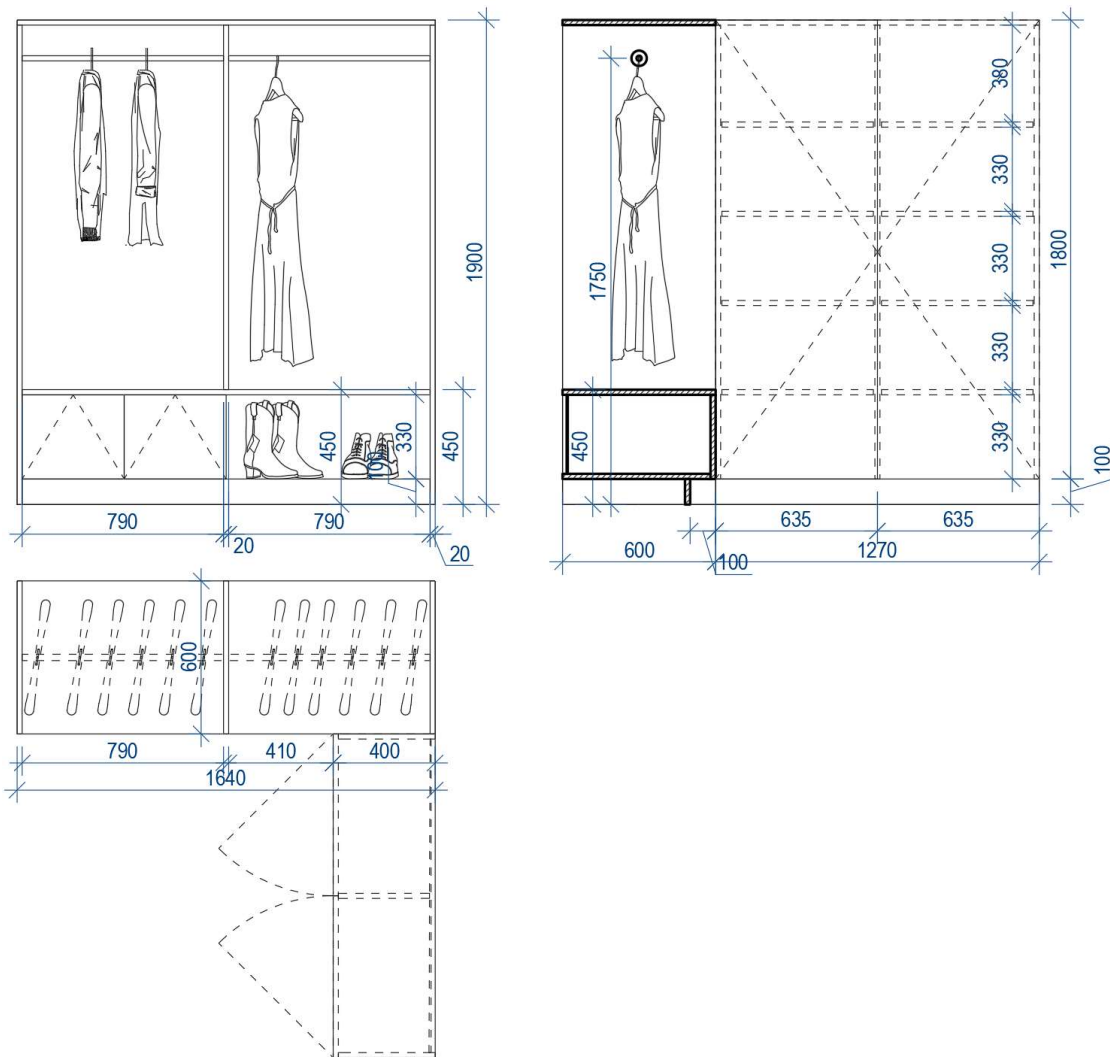

**HANDLES:** TRUKME, UA116-360,  
MAT BLACK

**LAMINATE:** EGGER U707  
ST9 - Silk Grey

## MEETING ROOM

-Foldable and movable table. Metal-white, worktop-white or light wood (depends on chosen floor)

-Meeting chairs. Upholstered in light grey, magenda and blue fabric, with wheels



## BASEMENT MEETING ROOM

-Movable table. Metal-white, worktop-white or light wood

-Conference chairs

